

Play value

Our Throne Ring provides a very special seating experience. With an almost medieval appearance, this circle of chairs with arms is excellent for promoting communication due to the way the seats are positioned facing and next to one another. The cool, raw feel of the surface of the concrete differs from normal seating, and its generous size makes the Throne Ring a very special attraction that can be seen from afar. The concrete chairs are not only ideal for resting and chatting, they can also be incorporated into a whole range of exciting role-playing games.



Photo © Daniel Perales



Order No. 7.80100 Multi-Step



Order No. 7.80000 Throne Ring



Fundamental characteristics

- Unique and original
- High-quality design
- Incentive for playing: seating, round shape, role-playing games
- Movement: sitting, resting

Recommended for

- School children
- Young people
- Public play areas without supervision, such as playgrounds, parks or similar

Throne Ring Multi-Step



7.80000

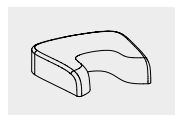

7.80100

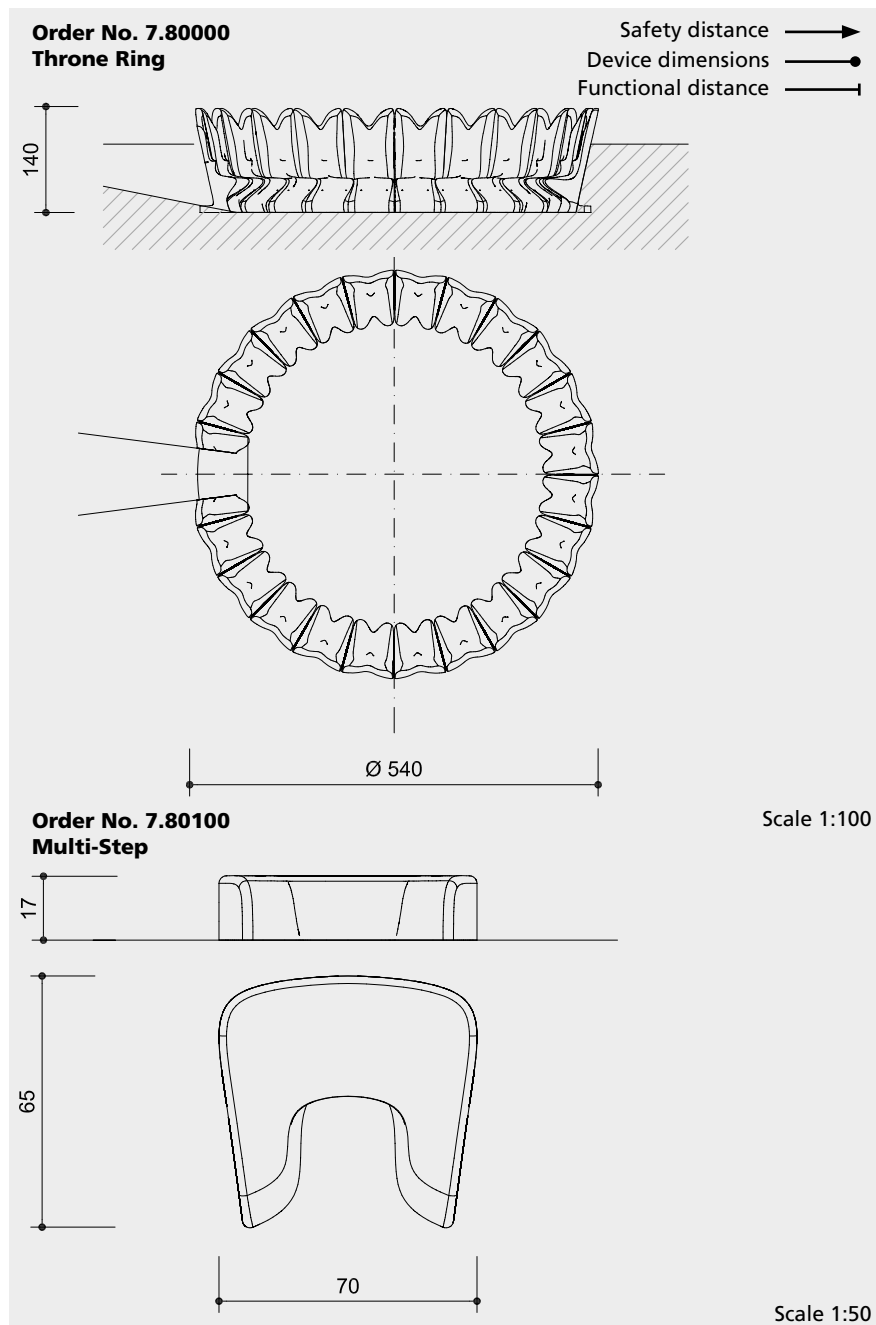

Technical information

Self-compacting reinforced concrete C40/50

Reinforcement

1 layer Q 196 galvanised
Connection pieces made of stainless steel

Blasted surface
Machined edges

Dimensions

(small deviations possible)

Order No. 7.80000

Throne Ring

Height	1.40 m
Length	5.40 m
Width	5.40 m
Weight of chair	approx. 250 kg
Total weight	approx. 6200 kg

Order No. 7.80100

Multi-Step

Height	0.17 m
Length	0.70 m
Width	0.65 m
Weight	100 kg

Safety check according to DIN EN 1176

Components

Order No. 7.80000

- 1 Throne ring incl. 22 chairs with support on the back
- 1 Half chair on the right
- 1 Half chair on the left
- Connection pieces

Order No. 7.80100

- 1 Multi-Step made of concrete C40/50

Installation information

Foundations
No foundations required.

Required space

Order No. 7.80000

Throne Ring

Approx. Ø 5.40

Order No. 7.80100

Multi-Step

Approx. 0.70 m x 0.65 m for each step

Attention:

Exact measurements may vary; for all installation dimensions refer to current assembly instructions.

Technical changes reserved.



7.80000

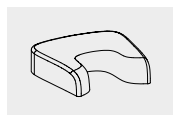

7.80100