

**Play value**

The most basic experience that we can find in water is its inner movement. The characteristic flow forms can be traced back to only a few basic patterns. Whilst working at the Institute for Flow Science of Theodor Schwenk, John Wilkes was engaged in the study of flow forms and so-called wall surfaces for flowing liquids. He discovered the phenomenon of rhythmical pulsation. In the chamber-shaped vessels of the Virbela installation the flowing water turns into a rhythmic pulsation which creates a flat figure-of-eight (lemniscate). The Virbela Basins are suitable for all areas where people are united together around the very nature of water. The installation is also suitable for improving the quality of water. The vessels have been installed in many biological purification plants in the past years.

**Recommended for**

- Kindergarten children
- School children
- Public play areas without supervision, such as playgrounds, parks or similar
- Water play areas without supervision



**Virbela-Original Shape**  
*graubner* Play Stations for  
 Developing the Senses

Vandalism	not vulnerable
Supervision	not necessary
Explanation Board	not necessary
Installation	outdoors
Safety check (DIN EN 1176)	not necessary
Installation in concrete	possible

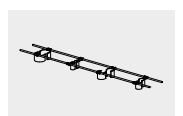

**Order No. 10.18500**  
**Virbela-Original Shape**

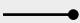
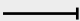
Safety distance   
 Device dimensions   
 Functional distance 

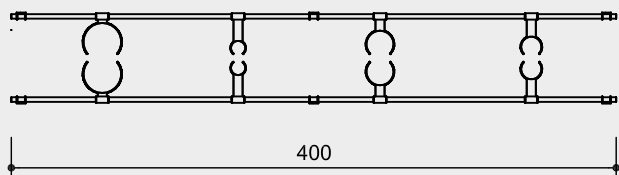
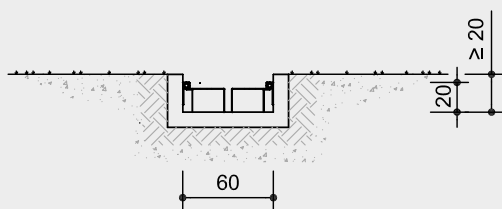

Scale 1:50

Safety check according to DIN EN 1176

**Components**

8 Flow obstacles with 2 guideways and fastening material for installation into a stream bed prepared on site

**Trademark**

30 2005 500 000 Germany  
 40-0682207 South Korea

Explanation board on request

**Installation information**

Recommended space  
 4.00 x 2.60 m

Foundations  
 Depends on the layout of the entire site

**Attention:**  
**Exact measurements may vary;**  
**for all installation dimensions refer**  
**to current assembly instructions.**  
 Technical changes reserved.

**Technical information**

Equipment made of stainless steel

Movable flow obstacles designed according to the laws of flow

**Dimensions**

(small deviations possible)

Height 0.20 m  
 Length 4.00 m  
 Width 0.60 m

Stream bed  
 Height min. 0.20 m  
 Length 4.00 m  
 Width 0.60 m

Flow obstacle  
 Diameter 0.10 - 0.25 m  
 Weight 40 kg

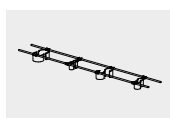

**10.18500**